

GREAT SCHOOLS
DESERVE
GREAT WINDOWS



WAUSAU

WINDOW AND WALL
SYSTEMS

ADVANTAGE BY WAUSAU PROVIDES DURABLE
PRE-ENGINEERED STANDARD WINDOWS FOR
COMPETITIVE, FAST-TURN
PUBLIC EDUCATION PROJECTS NATIONWIDE.
WAUSAU SUPPORTS YOUR SUSTAINABLE
DESIGN GOALS, AND OFFERS AN
INDUSTRY-LEADING STANDARD LIMITED
WARRANTY OF UP TO 10 YEARS.





2250i
3250i
4250i
4250i OFFSET

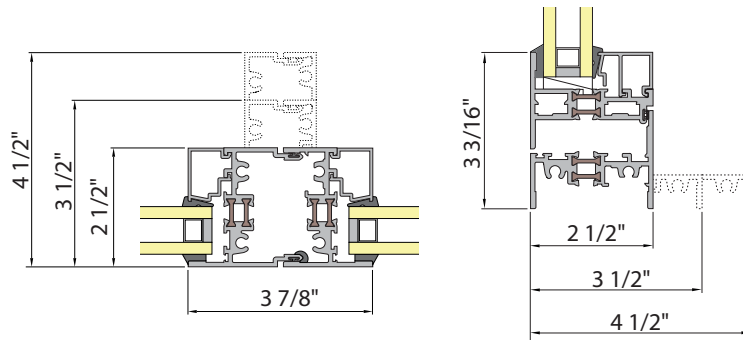

Allowable Air	Water	NFRC U-Factor	CRF _f	STC
0.10 cfm/sqft at 6.24 psf	15 psf	0.33 to 0.63 BTU/hr.sqft.°F	44 to 68	31 to 43 OITC 26 to 31

NFRC U-Factors as low as 0.19_{BTU/hr.sqft.°F} (R 5.3) can be achieved using triple insulating glass in 2250i-XLT fixed windows

- 2½", 3½" and 4½" frame depth with polyamide thermal barrier for two-color finish option
- AAMA AW-100 Architectural Performance Class
- Fixed, project-in hopper, project-out awning, or casement
- Integral blinds with access doors available
- 1/8" wall thickness at hardware attachments
- Multi-lock hardware option for improved accessibility
- XLT option features extra-wide thermal barrier, glazed-in muntin grid option for historical renovation
- Polyurethane thermal barrier available in standard 2250, 3250 and 4250 Series

XLT

**SUPERIOR ENERGY EFFICIENCY AND
CONDENSATION RESISTANCE**

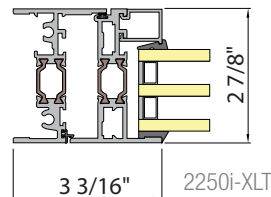

2250i-XLT

310i SINGLE HUNG

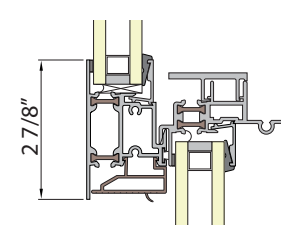

Durable AW100 Architectural Class hung windows, with polyamide thermal barrier and standard Caldwell Ultralift® counter-balancing hardware



3250-LP AND 4250-LP SIMULATED DOUBLE HUNG

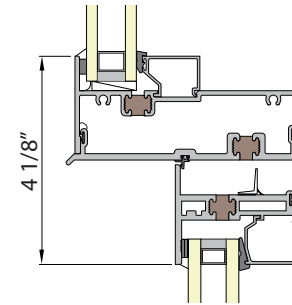

Projected windows with offset glass planes to replicate existing double-hung sash, but with the ease of operation, durability and low air infiltration of compression seals



410i HORIZONTAL ROLLING

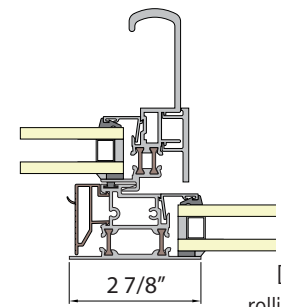

Durable AW70 Architectural Class rolling windows, with polyamide thermal barrier and rigid five-member frame construction



...the future of windows...

PRODUCTION LINE SAMPLING, INCLUDING INSPECTION AND **WATER TESTING PRIOR TO SHIPMENT**, ENSURES REAL-WORLD PERFORMANCE EQUAL TO THE LAB



SUPERWALL
SHIPS IN THREE WEEKS
ANY COLOR
INCLUDING
COPPER ANODIZE AND
CUSTOM "TEAM COLORS"

SUPERWALL PLUS ENTRANCES AND STOREFRONT

- 2 1/2" exterior sightline - Accent covers available
- 3/8" thermal separation
- Captured or vertical structural glazed
- Splayed mullions available for segmented radii
- Screw-spline construction
- Zero sightline vents available
- Clear Story™ exterior sun shades and interior light shelves available
- Complete selection of complementary storefront and entrances, including thermal doors

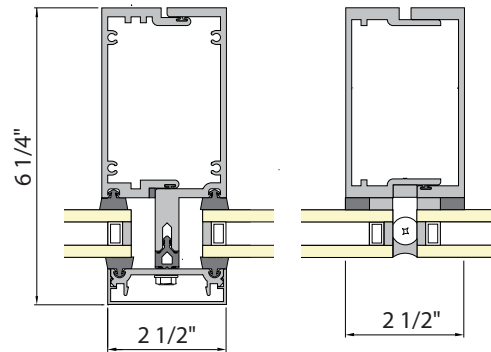

ATTENTION GLAZING CONTRACTORS:

ADVANTAGE BY WAUSAU OFFERS
PRE-ENGINEERED STANDARD PRODUCTS
FOR COMPETITIVE PRICING
AND QUICK DELIVERY

DESIGN AND SUBMISSION
ENGINEERING SUPPORT TOOLS HELP
ENSURE PROMPT APPROVAL OF YOUR
SHOP DRAWINGS AND CALCULATIONS

AUTOCAD® .DWG DETAILS
TEST REPORTS
NFRC LABELS AND THERMAL MODELS
SAMPLES
ANCHORAGE RECOMMENDATIONS
INSTALLATION INSTRUCTIONS

ALL AVAILABLE 24/7 AT
WWW.WAUSAUWINDOW.COM

ADVANTAGE
BY WAUSAU

WINDOW REPLACEMENT PANNING AND MUNTIN GRIDS

Removal of existing operable sash only, leaving frames in place, speeds installation and minimizes disruption - An extruded aluminum "panning" system prepares the opening

Muntins are available as true divided lites, glazed-in grids, silicone-applied or between-glass

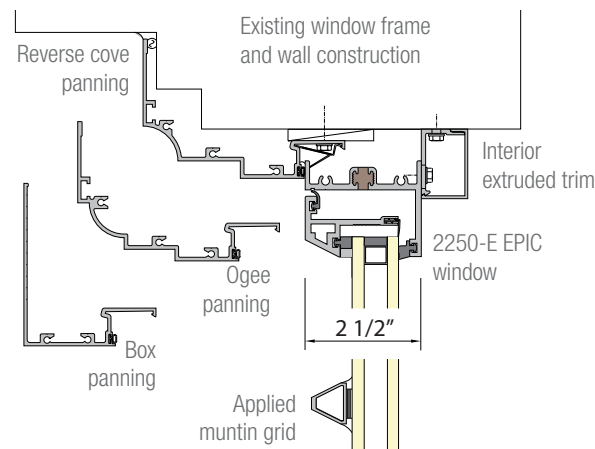

ATTENTION ARCHITECTS: WANT TO UPGRADE YOUR STANDARD SCHOOL WINDOW SPECIFICATIONS? SEND US AN E-MAIL AT EDUCATION@WAUSAUWINDOW.COM TO PREVIEW THE AIA CES PROGRAM "WINDOW SELECTION FOR SUSTAINABILITY AND LONG-TERM PERFORMANCE"



Lawrence School, Herkett, New York, JA Grillo Architects

HOW CAN WINDOWS CONTRIBUTE
TO LEED® FOR SCHOOLS?

LOW U-FACTOR
LOW SOLAR HEAT GAIN
NATURAL VENTILATION
DAYLIGHTING AND VIEWS
NOISE CONTROL
RECYCLED ALUMINUM FRAMES

WHY ALUMINUM WINDOWS ?

LONG-TERM DURABILITY
WEATHER RESISTANCE
MATERIAL STABILITY
LARGE OPERATING VENTS
RECYCLED CONTENT
ECO-FRIENDLY FINISHES
THERMAL BARRIER FRAMES

SUSTAINABLE MANUFACTURING
PROCESSES

- Minimized packaging materials in receiving and shipping
- Scrap recycling: Aluminum, steel, cardboard, wood, glass, fluorescent bulbs, paper, beverage containers, toner cartridges, electronic equipment
- "Paperless" environment supported by Wausau ShopView™ software
- 100% of VOCs captured in spray painting of durable AAMA 2605-tested fluoropolymer
- No-VOC finish options: Powder coatings and durable Class I anodic finishes with eco-friendly etch
- Resource-wasting internal rework minimized through Lean/Six Sigma

SUSTAINABLE BUSINESS
PRACTICES

- Leadership within industry trade organizations and research groups
- Collaborative design supported with engineering resources
- New LEED-Silver certified manufacturing facility
- LEED-AP on staff

BEYOND LEED®



WAUSAU

WINDOW AND WALL
SYSTEMS

DOWNLOAD COMPREHENSIVE DETAILS AND
SPECIFICATIONS AT WWW.WAUSAUWINDOW.COM

7800 INTERNATIONAL DRIVE WAUSAU, WI 54401
TOLL FREE 1 877 678 2983 FAX 1 715 843 4350
E-MAIL EDUCATION@WAUSAUWINDOW.COM